

Sanctioned subject to demolition of existing structure to provide open space as per plan before construction is started.

Approved by M.B.C. dt. 12.11.2014

APPROVED ASSISTANT ENGINEER (C) BOROUGH No. XIV

PROJECT
PROPOSED G+X STORIED RESIDENTIAL BUILDING AT PRE.NO. 126, RAMAKRISHNA SARANI, MOUZA -BEHALA, J.L.NO-2, R.S. DAG.NO. 7373,7374, KHATIAN NO.- 267, WARD NO.- 130, BOROUGH - XIV. DIST.- SOUTH 24 PARGANAS.

SPECIFICATIONS

1. ALL DIMENSIONS ARE IN MM UNLESS IT IS MENTIONED
2. ALL EXTERNAL BRICK WALLS ARE 230 MM THICK AND INTERNAL 125 MM THICK UNLESS IT IS MENTIONED
3. ALL BRICKWORK PLASTERING INSIDE OR OUTSIDE ARE IN THE RATIO OF 1:6:8:14 RESPECTIVELY AND OUTSIDE PLASTERING CONTAINS WATER PROOFING
4. ALL CIVIL WORKS ARE AS PER IS 456 AND ALL REINFORCEMENT AS PER IS 1176
5. ALL R.C.C. WORKS ARE IN THE RATIO M-25
6. ALL PRECAUTIONARY MEASURES SHALL BE TAKEN AT THE TIME OF CONSTRUCTION OF SEMI UNDERGROUND
7. DEPTH OF WATER RESERVOIR SHALL NOT BE MORE THAN THE DEPTH OF MAIN COLUMN FOUNDATION

DOOR-WINDOW SCHEDULE

DOORS			WINDOWS		
TYPE	WIDTH	HEIGHT	TYPE	WIDTH	HEIGHT
D1	750	2100	W1	600	900
D2	900	2100	W2	900	1550
D3	1100	2100	W3	1000	1200
D4	1000	2100	W4	1200	1200
D5	1800	2100	W5	1500	1800
SLD	1800	2100	W6	450	1800

ARCHITECT'S CERTIFICATE

THE PLOT HAS BEEN INSPECTED BY ME AND ON THAT BASIS I DO CERTIFY WITH FULL RESPONSIBILITY THAT THE PROPOSED BUILDING PLAN HAS BEEN DRAWN AS PER PROVISION OF K.M.C. BUILDING RULE 2009 AS AMENDED FROM TIME TO TIME. THE PLOT IS DEMARCATORY BY BOUNDARY WALL ON ALL FOUR SIDES. THE SITE PLAN AND LOCATION PLAN CONFORMS THE SITE.

Debatosh Sahu
DEBATOSH SAHU
 Architect + Urban Designer
 Regn. No. CA/89/12368

DEBATOSH SAHU
 Regn. No. CA/89/12368
 35A, Dr. Sarat Banerjee Road, Kolkata-700 029
 SIG. OF ARCHITECT & SEAL

STRUCTURAL ENGINEER'S CERTIFICATE

THE STRUCTURAL DESIGN AND DRAWINGS OF BOTH FOUNDATION & SUPERSTRUCTURE OF THE BUILDING HAS BEEN MADE BY ME CONSIDERING ALL POSSIBLE LOADS INCLUDING THE SEISMIC LOAD AS PER THE NATIONAL BUILDING CODE OF INDIA AND CERTIFIED THAT IT IS SAFE AND STABLE IN ALL RESPECTS.

K. Sengupta
KOUSHIK SENGUPTA
 B.E. (CIVIL), M.E. (STRUCTURE)
 REG-1779 (K.M.C.)

KOUSHIK SENGUPTA
 SEE No. 1/15
 SIG. OF STRUCTURAL ENGINEER & SEAL

UNDERSIGNED HAS INSPECTED THE SITE AND CARRIED OUT SOIL INVESTIGATION THEREON. IT IS CERTIFIED THAT THE EXISTING SOIL OF THE SITE IS ABLE TO CARRY THE LOAD COMING FROM PROPOSED CONSTRUCTION AND THE FOUNDATION SYSTEM PROPOSED HEREIN IS SAFE AND STABLE IN ALL RESPECT FROM GEO-TECHNICAL POINT OF VIEW.

Alok Roy
ALOK ROY
 Empowered Geotechnical Engineer
 Kolkata Municipal Corporation
 Class. No. G/1/11
 6A, Misan Park,
 Kolkata-700 084
 ALOK ROY
 SITE No. 1/11
 SIG. OF GEO-TECHNICAL ENGINEER

TOP PROJECTS PVT. LTD.
Pranab
 Director

SIGNATURE OF OWNER & SEAL

TITLE	
DATE	

DRAWN	Manish	REF.
CHECKED		SCALE
DEALT		

ESPACE
 35A, DR. SARAT BANERJEE ROAD, KOLKATA-700029
 TEL: 9830041418
 FAX: 9830041418
 E-MAIL: space@rediffmail.com
 WEBSITE: www.spaceindia.com

THIS DRAWING IS A PROPERTY OF ESPACE. 35A, DR. SARAT BANERJEE ROAD, KOLKATA-700029. ANY MODIFICATION, CHANGE/DEVIATIONS IS NOT PERMISSIBLE WITHOUT PRIOR PERMISSION TO ESPACE. IN THE CONTRARY THIS WILL BE TREATED AS ILLEGAL ACT.

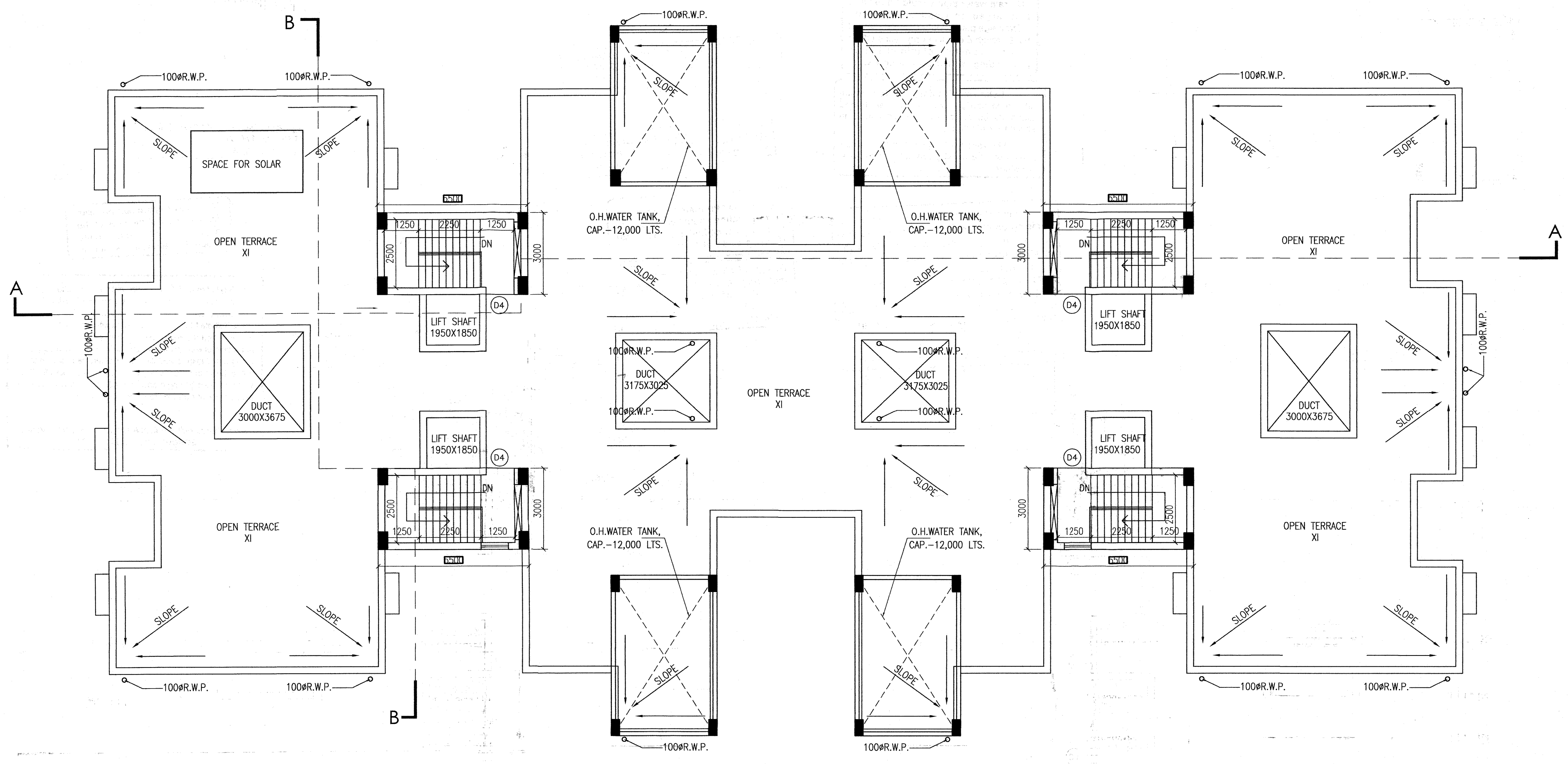

ROOF PLAN BLOCK-1

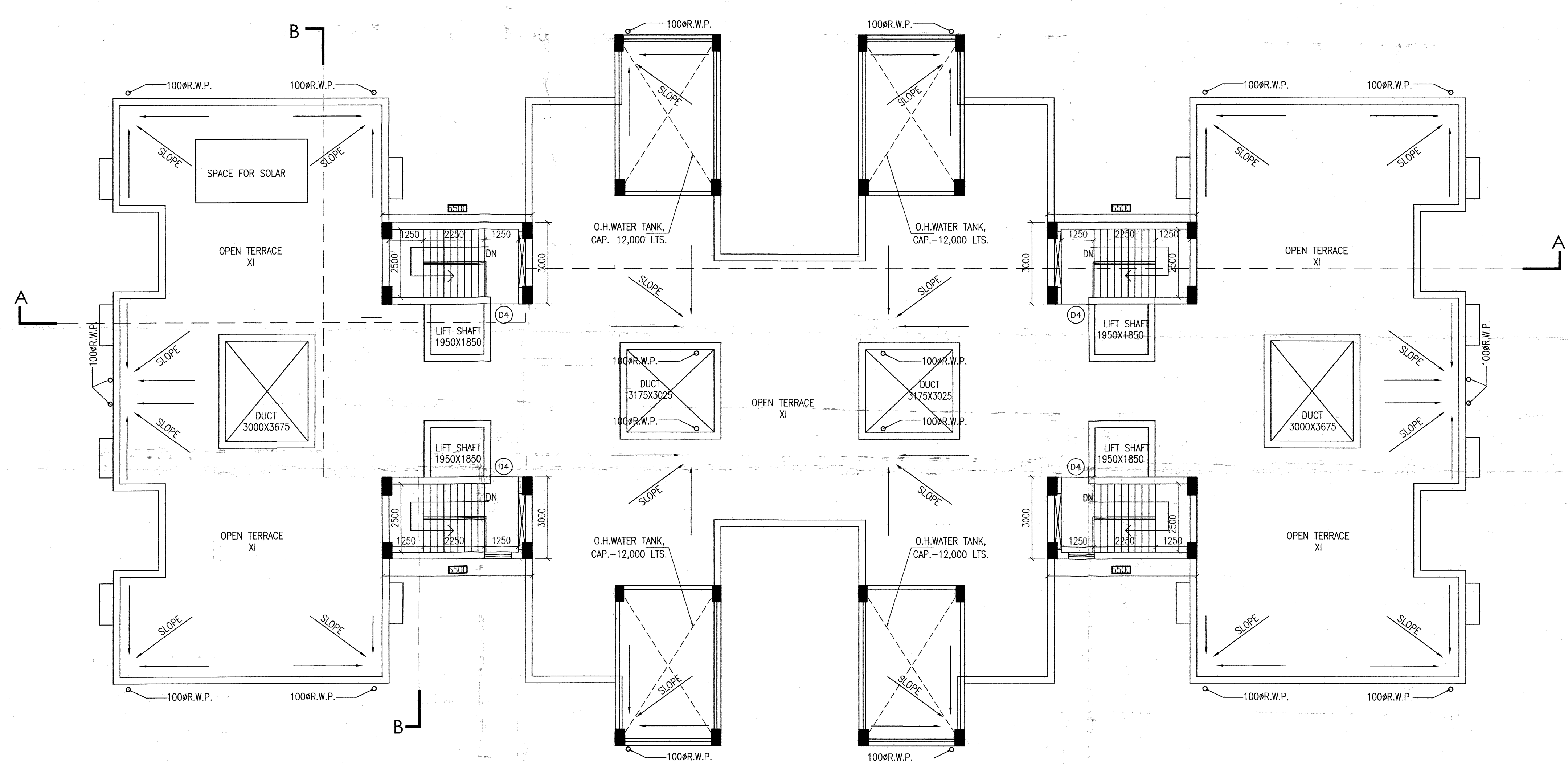

ROOF PLAN BLOCK-2